

SouthCliffe

A Geothermal Community

SouthCliffe-Homes.com

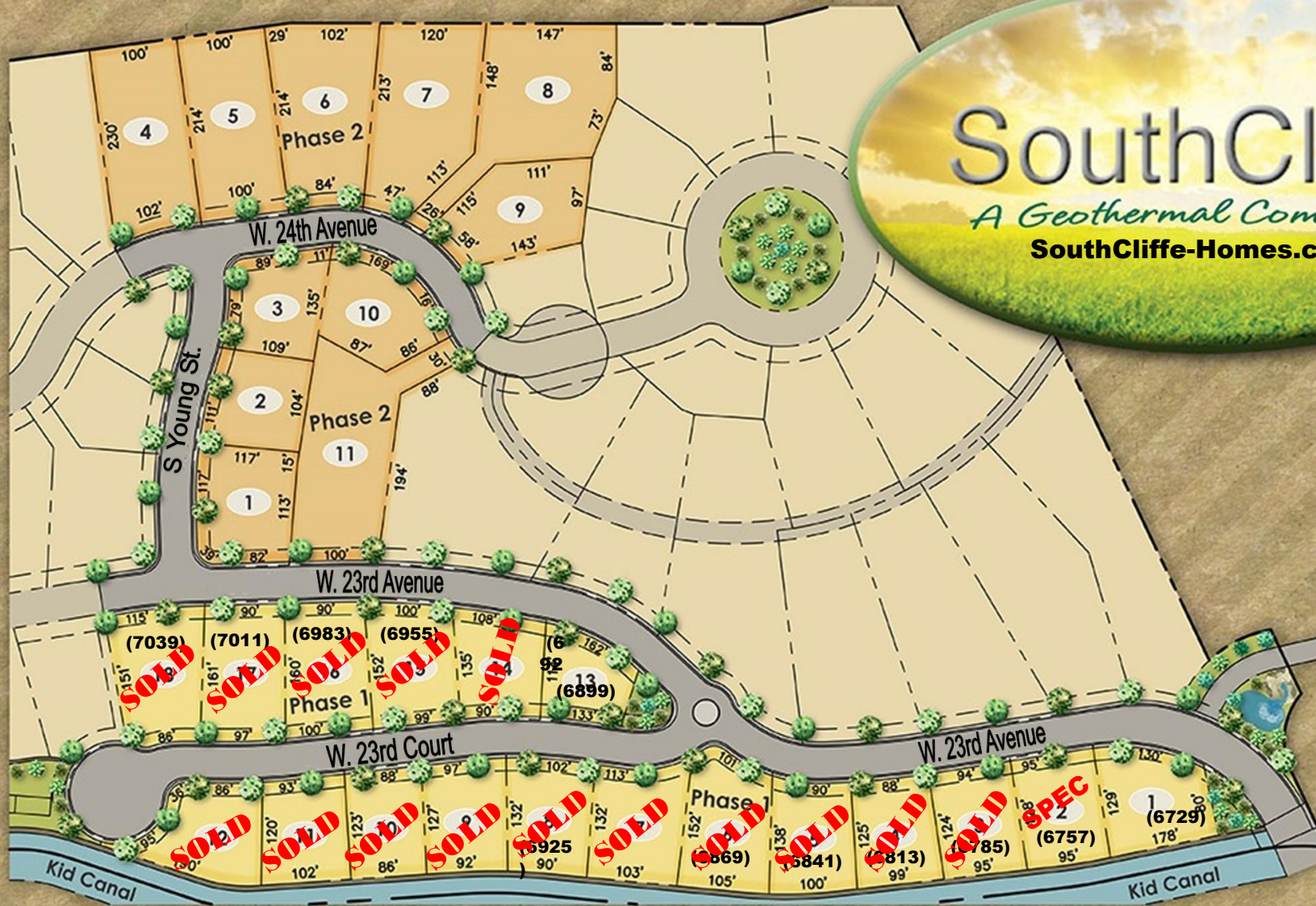

This is an artistic rendering - exact placement of amenities subject to change during construction.

From 395, West on Hildebrand for 1/2 mile,
then right on Sherman to SouthCliffe

At SouthCliffe, you will not only enjoy living in a convenient hillside community, but you will enjoy a money-saving, environmentally friendly energy source designed to support geothermal systems to heat and cool your home. While conventional homes use air conditioners, heating units, and hot water heaters, a single geothermal unit has the ability to heat and cool your home, and provide the majority of your home's hot water. A geothermal system will reduce your monthly utility bills by 30 to 70% compared to conventional systems.



Lot 7
Reserved

Lot 8
Reserved

Lot 9
Reserved

Lot 10
Reserved

Lot 11
Reserved

Lot 6
Available

Lot 5
Reserved

Lot 4
Reserved

Lot 3
Reserved

Lot 2
Reserved

Lot 1
Reserved

Park

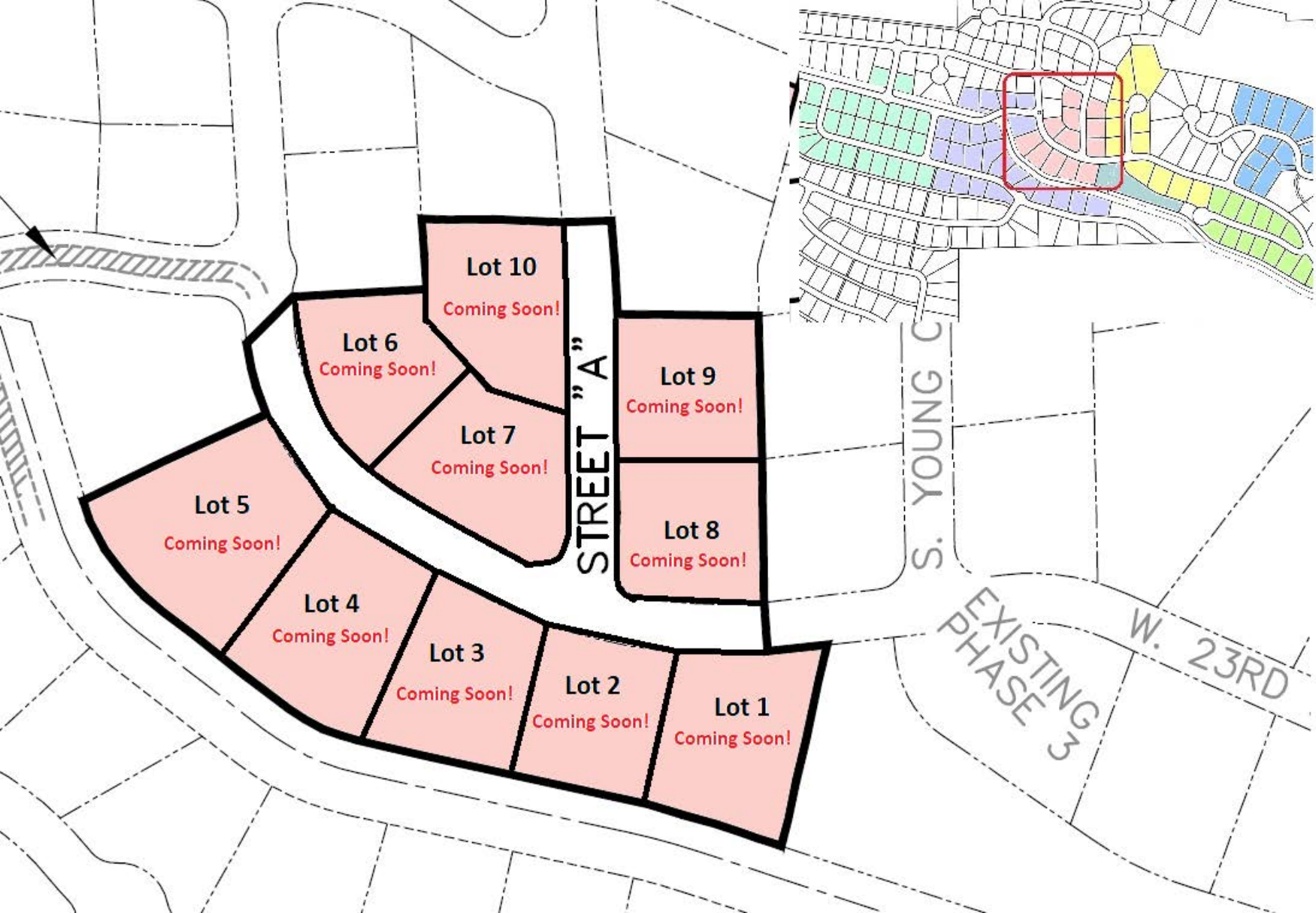

Lot 10

Coming Soon!

Lot 6

Coming Soon!

Lot 7

Coming Soon!

Lot 9

Coming Soon!

Lot 8

Coming Soon!

Lot 5

Coming Soon!

Lot 4

Coming Soon!

Lot 3

Coming Soon!

Lot 2

Coming Soon!

Lot 1

Coming Soon!

STREET "A"

S. YOUNG C.

**EXISTING
PHASE 3**

W. 23RD